

# A Snapshot of Gratiot County, Michigan



## 2016 Monthly Calendar

*featuring stories about economic, social, and educational developments in Gratiot County in the last year*



**Greater Gratiot  
Development, Inc.**

136 S. Main St., Ithaca, MI 48847

(989) 875-2083

[www.gratiot.org](http://www.gratiot.org)

*Celebrating 38 years of serving the Gratiot Community (1978-2016)*

# About Greater Gratiot Development, Inc.

Greater Gratiot Development, Inc. (GGDI) was incorporated in 1978 to coordinate economic development and related services on behalf of the area municipalities and the County of Gratiot. GGDI acts as a countywide clearinghouse for information and assistance in the retention, expansion, & location of businesses in Gratiot County. Additionally, GGDI initiates and participates in other activities designed to improve the economic climate in the Gratiot Community. Check out the fun facts below to learn more!



For more information, visit [www.gratiot.org](http://www.gratiot.org) !



GGDI countywide economic development services are supported by the Agriculture & Economic Development millage of Gratiot County.

Since 1978, GGDI has assisted in **271 projects** resulting in **\$65.8 million** in additional tax revenue and the creation of **2,391 net jobs**.



GGDI has assisted in the procurement of **\$10.8 million** in grant dollars for various projects resulting in direct benefits and/or savings to Gratiot citizens.

GGDI works with a number of **local**, **regional**, and **state** partners in order to successfully complete business & community projects.



GGDI projects and developments cross the entire county and involve almost all economic sectors, with a focus on those projects which are of base economic significance. If you have an idea or know of a project opportunity, please contact GGDI.



GGDI administers the **Brownfield Program**, which has led to the **redevelopment of several environmentally-challenged sites**, **455 net jobs**, and **\$25 million** in new investment.

Collaborative partners include:

- Gratiot Area Chamber of Commerce
- Michigan State University Extension
- Michigan Small Business Development Center
- Michigan Economic Development Corporation

# January 2016

Sunday	Monday	Tuesday	Wednesday	Thursday	Friday	Saturday
27	28	29	30	31 New Year's Eve	1 New Year's Day Kwanzaa ends	2
3	4	5	6	7	8	9
10	11	12	13	14	15	16
17	18 Dr. Martin Luther King, Jr. Day	19	20	21	22	23
24	25	26	27	28	29	30
31	1	2	3	4	5	6

Collaborating to shape the Gratiot Community....



Notes:

---



---



---



---

Sponsored by:



# Plasti-Paint, Inc.

# PPI

St. Louis, MI (Woodside Industrial Centre)

Employees: 76

Established: 1991

PPI specializes in advanced painting of plastic parts and components for the automotive, agricultural, and recreational vehicle markets.

2015 Project: 10,000 sq. ft. building expansion and additional equipment (state-of-the-art robotic paint sprayers)



Plasti-Paint, Inc. (PPI) has additional locations in Iowa and Georgia but is headquartered in St. Louis, Michigan. PPI is a global supplier of painted vehicle parts to 9 countries worldwide, including Mexico, Germany, Thailand, and China.



PPI is committed to investing in its people and technology to better serve their customers. The recent expansion includes a building for more storage and warehouse space (right) and a new spindle line to enhance the painting process (above).



Diversification is one of PPI's keys to success; PPI supplies many industries: automotive (10 of the biggest companies), recreational (Yamaha, Polaris, & Honda), agricultural (John Deere & Caterpillar), and consumer products (GE appliances).



*"Plasti-Paint has looked to GGDI for over 25 years as a conduit between state and local government. That process has allowed PPI to direct its focus on the task at hand while having the confidence that necessary documentation would reach the proper channels."*

-David Bacon

President

[www.plastipaint.com](http://www.plastipaint.com)



# February 2016

Sunday	Monday	Tuesday	Wednesday	Thursday	Friday	Saturday
31	1	2	3	4	5	6
7	8	9	10	11	12	13
14 Valentine's Day	15 Presidents' Day	16	17	18	19	20
21	22	23	24	25	26	27
28	29 Leap Day	1	2	3	4	5

Collaborating to shape the Gratiot Community....



**Greater Gratiot Development, Inc.**  
 136 South Main, Ithaca, MI 48847  
 Ph: (989) 875-2083  
[www.gratiot.org](http://www.gratiot.org)

Notes:

---



---



---



---

Sponsored by:



**ITC**  
[www.itctransco.com](http://www.itctransco.com)

Plasti-Paint, Inc.



Class A Base Coat **PP1** & Clear Coat Painting



Lightweighting without compromise.™

[www.shiloh.com](http://www.shiloh.com)

Alma, Michigan

Employees: 89

Established: Shiloh Industries purchased Contech Castings in 2013  
Shiloh Industries is a leading provider of high-pressure aluminum die cast parts for the automotive industry.

2015 Project: \$16.5 million expansion to include plant redevelopment, upgrades to existing equipment, and purchase of new machinery & equipment



*"It has been great working with Greater Gratiot Development, Inc. and the City of Alma to help make this project come to fruition. The support we have received through the entire process has been excellent and has proven to be a significant factor in the growth at the Shiloh-Alma facility."*

**-Dustin McDonald  
Plant Manager**

Shiloh products are used in various cars and light trucks, including the Silverado, Sierra, Corvette, Yukon, Encore, Traxx, Dodge Journey, Nissan Frontier, and other foreign cars.

Shiloh-Alma produces aluminum die castings for the automotive industry, with a focus on the steering and powertrain market segments. Approximately 4 million parts are shipped out annually to customers all around the world, including South Korea and China.



This expansion was necessary due to a project order Shiloh received. The project entails designing and installing a manufacturing system for a cast and machined aluminum planetary carrier that will be used in GM's new 9-speed transmission. This new part will go into nearly all of GM's front wheel drive vehicles.



Shiloh-Alma employees average 14 years of service!



Shiloh's expansion is expected to create 45 jobs. The Michigan Economic Development Corporation (MEDC) awarded \$1 million in Community Development Block Grant funds to Shiloh for job training activities including employee onboarding, new equipment/tooling training, and necessary technical training to operate and maintain the new equipment. For more information on the MEDC's business assistance programs, visit [www.michiganbusiness.org](http://www.michiganbusiness.org).



# March 2016

Sunday	Monday	Tuesday	Wednesday	Thursday	Friday	Saturday
28	29 Leap Day	1	2	3	4	5
6	7	8	9	10	11	12
13 Daylight Saving Time (Start)	14	15	16	17 St. Patrick's Day	18	19
20	21	22	23	24	25 Good Friday	26
27 Easter	28	29	30	31	1	2

Collaborating to shape the Gratiot Community....



Notes:

---



---



---



---

Sponsored by:



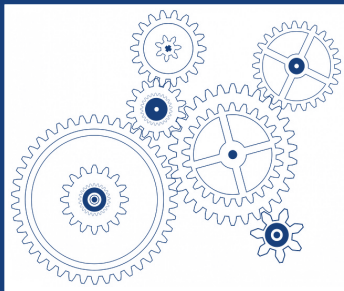

The Central Michigan Manufacturers Association (CMMA) is a membership association formed to address a variety of needs facing manufacturers in Central Michigan (Clare, Gladwin, Gratiot & Isabella counties). The CMMA is a collaborative network that promotes the exchange of ideas and best practices in the industrial community, resulting in the betterment of all members. Check out the information below to learn more about the Association's work to advance manufacturing in Central Michigan or visit [www.centralmichiganmanufacturers.org](http://www.centralmichiganmanufacturers.org).

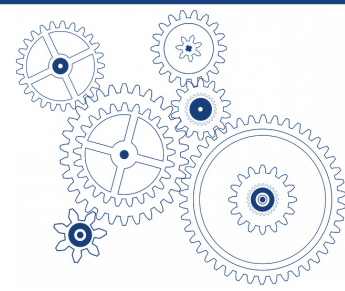

## Networking



The CMMA offers member companies a chance to form collaborative relationships through networking events (top) and training opportunities (right).



## Workforce Development



The CMMA supports high school career & technical education programs through participation in events like the Gratiot-Isabella Technical Education Center Open House & Career Expo (below) and industry tours (left).

## Scholarships



Up to two scholarships are available for students that have plans to promote manufacturing in their careers. Recipients must be employed, or related to an employee, at a CMMA member company.



In an effort to promote manufacturing careers, Greater Gratiot Development, Inc., in conjunction with the CMMA, created a video to promote skilled trade education programs in the Mid-Michigan area. To view the video, please scan the QR code, or visit [www.gratiot.org/1/292/experience\\_gratiot.asp](http://www.gratiot.org/1/292/experience_gratiot.asp).





# April 2016

Sunday	Monday	Tuesday	Wednesday	Thursday	Friday	Saturday
27 Easter	28	29	30	31	1	2
3	4	5	6	7	8	9
10	11	12	13	14	15	16
17	18	19	20	21	22 Earth Day	23 First Day of Passover
24	25	26	27 Administrative Professionals' Day	28	29	30 Passover ends

Collaborating to shape the Gratiot Community....



Notes:

---



---



---



---

Sponsored by:



# Celebrating Small Businesses in Gratiot County

National Small Business Week is May 1-7, 2016. Most businesses in the manufacturing sector are considered a small business if they have 500 employees or less. This is the case for almost all manufacturers in Gratiot County, proving that small businesses of all types are crucial to our local economy. Check out these fun facts to see how small businesses in Gratiot County are a big deal around the world.

### Garr Tool Company

(Pine River Twp., MI; FTE: 141; [www.garrtool.com](http://www.garrtool.com))

Garr Tool produces 14,000 carbide cutting tools DAILY! 600-700 boxes per day are shipped across North America and to 20 distributors that serve 40 countries worldwide! The company is expanding in 2016 and will have a 200,000 sq. ft. facility.



### Avalon & Tahoe Mfg., Inc.

(Alma, MI; FTE: 230; [www.avalonpontoon.com](http://www.avalonpontoon.com))

Avalon is the 5th largest pontoon boat manufacturer in the world. Avalon specializes in producing luxury pontoon boats of all sizes. In 2015, Avalon produced over 3,000 boats that shipped as far as South Africa! Avalon recently completed an expansion of their Alma facility.



### Aircraft Precision Products, Inc. (APPI)

(Ithaca, MI; FTE: 65 and counting; [www.aircraftprecision.net](http://www.aircraftprecision.net))

APPI, an employee-owned company, just completed a recent expansion. APPI produces jet engine parts that are sold across North America and internationally to 5 different countries.



### Apex Marine, Inc.

(St. Louis, MI; FTE: 89; [www.apexmarineinc.com](http://www.apexmarineinc.com))

Apex builds over 150 different models of compact and electric pontoon boats. Annually, they produce over 2,000 boats for distribution to dealers across North America. Apex has a plant expansion planned for 2016.



### Integrity Fab & Machine, Inc.

(Breckenridge, MI; FTE: 49 and counting; [www.ifabm.com](http://www.ifabm.com))

Integrity is the largest private sector employer in Breckenridge! Integrity produces a variety of fabricated metal parts that are shipped all over North America. In 2015, Integrity began an expansion of their facility in the Breckenridge Industrial, Technology & Agribusiness Park.

# May 2016

Sunday	Monday	Tuesday	Wednesday	Thursday	Friday	Saturday
1	2	3	4	5	6	7
8 Mother's Day	9	10	11	12	13	14
15	16	17	18	19	20	21
22	23	24	25	26	27	28
29	30 Memorial Day	31	1	2	3	4

Collaborating to shape the Gratiot Community....



Notes:

---



---



---



---

Sponsored by:



# Gratiot County: Explore Where You Live!

## Scenic Natural Resources

Two of Gratiot's greatest features are Hubscher County Park (Sumner—top left) and Reed County Park (North Star—bottom left). Open to the public, both parks boast a swimming beach, a playground, nature trails, various sports fields, pavilions, and picnic tables & grills. You can also enjoy the Pine River canoe / kayak trail (top right), accessible from picturesque Luneack County Park (Alma—bottom right).



## Arts & Culture Enrichment

Gratiot County offers various outlets for celebrating arts and culture. Festivals such as the Alma Highland Festival (top left) and Bannister Czechoslovak Harvest Festival (bottom left) celebrate local cultures. Theatre, dance, and musical performances can be enjoyed at venues such as the Alma College Heritage Center (top right) and the Alma Strand Theatre (bottom right) featuring the Gratiot County Players.



## Outdoor Entertainment

Outdoor activities are plentiful in Gratiot County for both spectators and participants! The Gratiot Area Chamber hosts an annual Agri-Fit 5K Challenge (top left), or you can set your own pace on the 42-mile long Fred Meijer Heartland Trail (bottom left) that starts in Alma and ends in Greenville, MI. The Splash Park in Breckenridge is fun for the whole family (top right), and Alma College offers a multitude of NCAA Division 3 sports events to attend (bottom right).



## Unique & Exciting Festivals

Celebrations for all seasons occur all over Gratiot County. In addition to the cultural celebrations listed above, there are a multitude of city and county events in which to take part, including:

- ◆ Rural Urban Day (top left)
- ◆ St. Louis Blues Festival (top right)
- ◆ Alma Fall Festival (bottom left)
- ◆ Ithaca Hometown Christmas (bottom right)



There is more to Gratiot County than meets the eye when it comes to recreational opportunities. From downtown shopping to river canoeing and symphony performances to street festivals, Gratiot County has it all! Get out and explore Gratiot County and all it has to offer! Scan the QR code to the left or visit Greater Gratiot Development, Inc.'s website ([www.gratiot.org/1/292/experience\\_gratiot.asp](http://www.gratiot.org/1/292/experience_gratiot.asp)) for videos depicting why Gratiot is a great place to live, work, and play. For more information on events and recreational opportunities, please visit [www.gratiot.org](http://www.gratiot.org).

# June 2016

Sunday	Monday	Tuesday	Wednesday	Thursday	Friday	Saturday
29	30 Memorial Day	31	1	2	3	4
5	6 First Day of Ramadan	7	8	9	10	11
12	13	14	15	16	17	18
19 Father's Day	20	21	22	23	24	25
26	27	28	29	30	1	2

Collaborating to shape the Gratiot Community....



Notes:

---



---



---



---

Sponsored by:



# Growing Gratiot: Farm to Table Agriculture



71% of land in Gratiot County is dedicated to harvested cropland, resulting in unique opportunities for consumers to buy a bountiful variety of crops from local farms. Not only is it reassuring to know where your food is coming from, but it also boosts the local economy. The Farmers Market Coalition reported that growers selling locally create 13 full-time farm operator jobs per \$ 1 million in revenue earned. For information on where to purchase Gratiot-produced agricultural products, check out the details below.



Gratiot County has a number of local and regional CSA (Community Supported Agriculture) programs serving the area. CSAs offer you a chance to purchase a weekly share of a farmer's produce from June to October. Featured below is Monroe Family Organics, a Certified Organic CSA in Elwell, Michigan with drop-off locations in Alma. For more information, please visit [www.localharvest.org/csa](http://www.localharvest.org/csa).



Farmers markets offer fresh produce, delicious baked goods, & unique craft items. Markets are held weekly in Alma, Ithaca, and Breckenridge; for dates and times, visit the city websites. Some vendors at the Alma and Ithaca Farmers Markets accept WIC Project Fresh (for women & children) and Market Fresh (for senior citizens) coupons, giving nutritionally-at-risk consumers access to fresh produce.



Would you like more information on how to utilize local fresh produce? Michigan State University Extension (MSUE) offers SNAP-Ed, a nutrition program that seeks to improve the likelihood that persons eligible for SNAP (Supplemental Nutrition Assistance Program) will make healthy choices within a limited budget and choose active lifestyles consistent with the current Dietary Guidelines for Americans and MyPlate. To accomplish this mission, MSUE offers several informational classes for anyone interested in Gratiot County: "Cooking Matters" (for adults and for teens), "Show Me Nutrition" (for kids), and "Eat Healthy, Be Active." For more information, call MSUE at (989) 875-5233.



# July 2016

Sunday	Monday	Tuesday	Wednesday	Thursday	Friday	Saturday
26	27	28	29	30	1	2
3	4 Independence Day	5 Ramadan ends	6	7	8	9
10	11	12	13	14	15	16
17	18	19	20	21 Rural Urban Day	22	23
24 Parents' Day	25	26	27	28	29	30
31	1	2	3	4	5	6

Collaborating to shape the Gratiot Community....



Notes:

---



---



---



---

Sponsored by:





Above: The new building will be used for painting and surface cleaning. Right: Duane Powell (CEO & President-Powell), Don Schurr (President-GGDI), and Norm Winterstein (CFO/COO-Powell).



Powell Fab has sold systems on every continent except Antarctica; systems have been sold in over 50 different countries!



This ILM Test Skid takes approximately 16 weeks to complete with 10 weeks in design and engineering and 6 weeks on the floor. Parts for the system come from around the world and are assembled in St. Louis, MI.



*“As we continue to expand, we appreciate all of the support and assistance provided by Don Schurr and the staff at Greater Gratiot Development, Inc.”*

-Duane Powell  
CEO & President



Powell technology is widely used in the United States and Canada; 70% of the bleach produced in North America comes from Powell continuous systems.



# August 2016

Sunday	Monday	Tuesday	Wednesday	Thursday	Friday	Saturday
31	1	2	3	4	5	6
7	8	9	10	11	12	13
14	15	16	17	18	19	20
21	22	23	24	25	26	27
28	29	30	31	1	2	3

Collaborating to shape the Gratiot Community....



Notes:

---



---



---



---

Sponsored by:



In 2014, Alma College received a \$5 million grant from The Herbert H. and Grace A. Dow Foundation to fund a STEM (science, technology, engineering, and math) education initiative: “e-STEM: Enhancing STEM Education and Practice.” The initiative provides new opportunities for students and faculty at both Alma College and K-12 schools to collaborate and engage in real-world research and learning in the academic disciplines of STEM through the four components mentioned below. Alma has also received over \$1 million in funding for scholarship and research opportunities from the National Science Foundation.

## Dow Digital Science Center



The DDSC provides highly advanced research opportunities for the collection and storage of data and remote sensing instrumentation. The grant also provides funding for local high schools to purchase equipment to interface with the DDSC.

## e-STEM Summer Camps



Summer science camps engage K-12 students with age-appropriate science experiences. The camps will feature side-by-side research with Alma College faculty and time to design DDSC projects for K-12 schools.

## Science Olympiad Support

Alma College faculty and Science Olympiad coaches help K-12 students and teachers become more familiar with program rules, the engineering and physics behind events, and how to create award-winning projects.

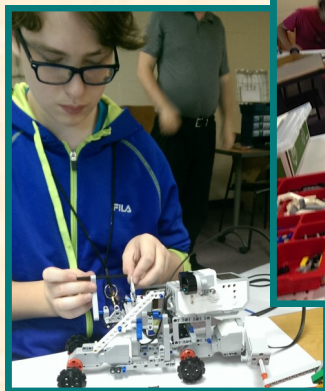

## Community Assistance



Alma College continuously looks for opportunities to work with community, education, and industry leaders to develop STEM projects that address local and regional problems. Projects include assisting with cleanup of the Pine River (left) and learning about different species like Alma, the Snowy Owl (above).

Alma College is a regional partner of the Great Lakes Bay Regional Alliance’s STEM Impact Initiative. The initiative unites regional education, industrial, and community leaders with a common mission: “To build the workforce of tomorrow through comprehensive STEM education and training to meet the growing needs of current employers and to attract new jobs and companies to the Great Lakes Bay Region.” For more information, please visit [www.stempipeline.com](http://www.stempipeline.com) or [www.alma.edu](http://www.alma.edu).

# September 2016

Sunday	Monday	Tuesday	Wednesday	Thursday	Friday	Saturday
28	29	30	31	1	2	3
4	5 Labor Day	6	7	8	9	10
11 Patriot Day Grandparents' Day	12	13	14	15	16	17
18	19	20	21	22	23	24
25	26	27	28	29	30	1

Collaborating to shape the Gratiot Community....



Notes:

---



---



---



---

Sponsored by:



# Gratiot County Quilt Trail

The Gratiot County Quilt Trail consists of a series of unique quilt squares hung on local farms, homes, and businesses around the County. This tourist attraction celebrates both the art of quilting and the history of local farms and businesses. Expected to be completed in 2016, the effort unites the rural and urban communities through promotional efforts that will encourage tourists to explore the countywide trail and support local businesses along the way. For information on touring the Gratiot County Quilt Trail, please visit the Gratiot Area Chamber of Commerce website: [www.gratiot.org](http://www.gratiot.org)



Local artists and quilters help design and paint the quilt squares with high-quality materials. Depending on the size (2' x 2', 4' x 4', or 8' x 8'), the squares are completed in pieces and assembled during installation.



Each square is individually designed for the establishment it will represent; many represent a story with significant meaning to the owners.\*

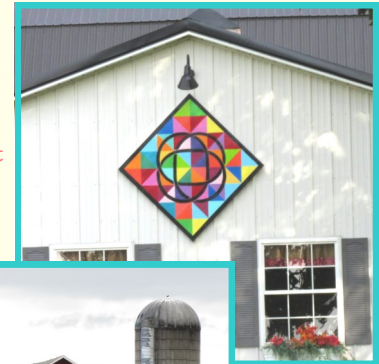

\*Pictures courtesy of Becky Dickman

# October 2016

Sunday	Monday	Tuesday	Wednesday	Thursday	Friday	Saturday
25	26	27	28	29	30	1
2	3 First Day of Rosh Hashanah	4 Rosh Hashanah ends	5	6	7	8
9	10 Columbus Day	11	12 Yom Kippur	13	14	15
16	17 National Boss's Day	18	19	20	21	22
23	24	25	26	27	28	29
30	31 Halloween	1	2	3	4	5

Collaborating to shape the Gratiot Community....



Notes:

---



---



---



---

Sponsored by:



Pine River Township, MI

Employees: 86

Gratiot County facility established in 2013  
Legend constructs high-quality all aluminum  
and steel trailers.

Recent project: New 10,000 sq. ft. painting  
process building with cross draft paint booth

# LEGEND

## ALL ALUMINUM TRAILERS



*"We chose to locate and expand our business in  
Gratiot County. Come grow with us—it's easy!"*

-Nathan Beck

President



In 2013, Legend purchased a  
former retail building in  
Alma, Michigan and  
revamped it into a  
manufacturing facility. The  
move allowed Legend to  
expand production and  
double its workforce.



Since establishing their new  
location, Legend has  
expanded its production  
capabilities to include two  
new aluminum models and a  
new line of steel trailers.



Legend produces a wide  
variety of products that are  
sold across the US and  
Canada: boat docks, ice  
fishing shanties, steel trailers,  
and high quality aluminum  
cargo, snowmobile, and  
utility trailers.

The recent expansion  
includes a 10,000 sq. ft.  
building for the painting of  
steel trailers (above) and new  
employees for steel welding  
(right).



[www.legendmfginc.com](http://www.legendmfginc.com)

# November 2016

Sunday	Monday	Tuesday	Wednesday	Thursday	Friday	Saturday
30	31 Halloween	1	2	3	4	5
6 Daylight Saving Time (End)	7	8	9	10	11 Veterans Day	12
13	14	15	16	17	18	19
20	21	22	23	24 Thanksgiving	25	26
27	28	29	30	1	2	3

Collaborating to shape the Gratiot Community....



Notes:

---



---



---



---

Sponsored by:



# Celebrate the Holiday Season in Gratiot County!

## *Come Home to Alma for the Holidays*



Come Home to Alma to celebrate the holiday season on the second Friday in December. In addition to a variety of special offers and delectable treats available at local merchants, you can enjoy the following:

- Parade
- Meeting Santa, Mrs. Claus, & reindeer
- Pony rides
- Children's crafts
- Caroling sleigh rides
- Christmas light tours
- Christmas Cash Giveaway drawing
- Dance performances
- Live music
- Jingle Bell Run/Walk 10K & 5K (Saturday morning after)



Visit [www.ci.alma.mi.us](http://www.ci.alma.mi.us) for more information.

## *Christmas in the Village of Breckenridge*



Breckenridge's Christmas in the Village is held on the first Monday in December. Downtown businesses will be offering various specials and giveaway items. Other activities include:

- Santa parade
- Christmas tree lighting
- Meeting Santa and his elves & reindeer
- Holiday trolley rides
- Inflatable Christmas decoration display
- Life-size Nativity scene
- Christmas caroling
- Children's crafts
- Tours from the Breckenridge Historical Society

Visit [www.breckenridgemi.com](http://www.breckenridgemi.com) for more information.

## *Ithaca's Hometown Christmas*



Ithaca's Hometown Christmas is held on the first Friday of December in the downtown area with shopping and dining opportunities. The event offers many seasonal activities:

- Children's story hour
- Santa Trot for Tots
- Chili cook-off
- Visiting Santa, Mrs. Claus, elves, & reindeer
- Christmas carolers
- Electric Santa parade
- Children's crafts
- 50/50 raffle

Visit [www.ithacami.com](http://www.ithacami.com) for more information.

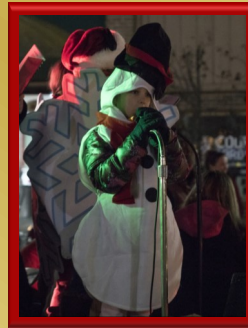

## *Small Town Family Christmas in St. Louis*



The Small Town Family Christmas celebration in St. Louis gives your family a chance to explore all that downtown St. Louis has to offer: picturesque Christmas decorations, unique shopping opportunities, and appetizing dining options. The event is held on the evening of the first Thursday in December. It includes a lighted Christmas parade, a chance to meet Santa, Mrs. Claus, & their reindeer, and a community reception offering free pulled pork, soup, cookies, and hot chocolate. Also check out the St. Louis High School Band as they perform the Holiday Festival of Bands.

Visit [www.stlouismi.com](http://www.stlouismi.com) for more information.

# Happy Holidays!



# December 2016

Sunday	Monday	Tuesday	Wednesday	Thursday	Friday	Saturday
27	28	29	30	1	2	3
4	5	6	7	8	9	10
11	12	13	14	15	16	17
18	19	20	21	22	23	24 Christmas Eve
25 Christmas Day First Day of Hanukkah	26 Kwanzaa begins	27	28	29	30	31 New Year's Eve

Collaborating to shape the Gratiot Community....



Notes:

---



---



---



---

Sponsored by:



# Michigan Certified Business Parks

Business development projects are only possible if sufficient appropriate land is available. Gratiot County boasts five Michigan Certified Business Parks. Certified Business Parks are typically government-owned and have readily available municipal services and aesthetically pleasing features. These combined factors make for a streamlined development process. Certified Business Parks are promoted internationally by the Michigan Economic Developers Association and the Michigan Economic Development Corporation.

Alma Industrial Park  
 Breckenridge Industrial, Technology and Agribusiness Park  
 Ithaca Industrial Park  
 St. Louis Woodside Industrial Centre  
 South Ithaca Industrial Park



MICHIGAN CERTIFIED BUSINESS PARK

For map downloads, scan the smartphone QR code or visit [www.gratiot.org](http://www.gratiot.org)



## Alma Industrial Park

Alma, Gratiot County, Michigan, USA Updated: August 2015

For more information on available properties or current companies, click on the available parcel or company logo.



**Legend**

- Available building
- Available site
- Park boundaries
- Established lot line
- Combination lot line
- Conceptual lot line

City of Alma (989) 463-8336  
 525 E. Superior St.  
 Alma, MI 48803  
[www.ci.alma.mi.us](http://www.ci.alma.mi.us)

**Greater Gratiot Development, Inc.**  
 136 South Main, Ithaca, MI 48847  
 Ph: (989) 875-2083  
[www.gratiot.org](http://www.gratiot.org)

For more information on Gratiot County's 5 Certified Business Parks, visit [www.gratiot.org](http://www.gratiot.org) or Scan this Smartphone QR Code:



**WOLVERINE ENGINEERS & SURVEYORS, INC.**  
 989-866-1500  
 4400 Westwood Drive, Ithaca, MI 48847  
 By: Wolverine Engineers & Surveyors, Inc.

## Ithaca Industrial Park

Ithaca, Gratiot County, Michigan, USA Updated: August 2015

For more information on available properties or current companies, click on the available parcel or company logo.

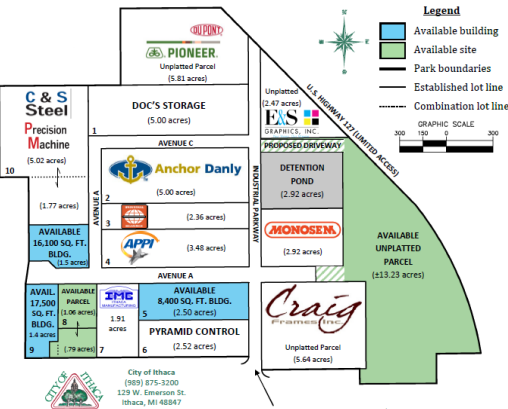

**Legend**

- Available building
- Available site
- Park boundaries
- Established lot line
- Combination lot line
- Conceptual lot line

City of Ithaca (989) 875-3200  
 129 W. Emerson St.  
 Ithaca, MI 48847  
[www.ithacami.com](http://www.ithacami.com)

**Greater Gratiot Development, Inc.**  
 136 South Main, Ithaca, MI 48847  
 Ph: (989) 875-2083  
[www.gratiot.org](http://www.gratiot.org)

For more information on Gratiot County's 5 Certified Business Parks, visit [www.gratiot.org](http://www.gratiot.org) or Scan this Smartphone QR Code:



**WOLVERINE ENGINEERS & SURVEYORS, INC.**  
 989-866-1500  
 4400 Westwood Drive, Ithaca, MI 48847  
 By: Wolverine Engineers & Surveyors, Inc.

## Breckenridge Industrial, Technology & Agribusiness Park

Breckenridge, Gratiot County, Michigan, USA Updated: August 2015

For more information on available properties or current companies, click on the available parcel or company logo.

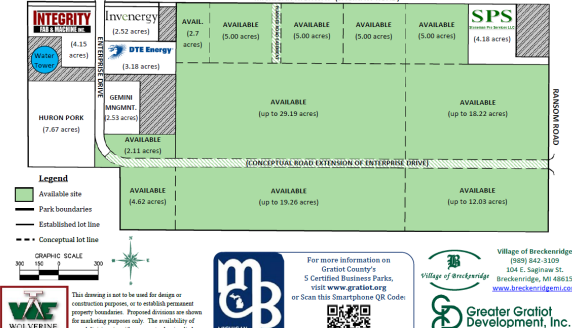

**Legend**

- Available site
- Park boundaries
- Established lot line
- Conceptual lot line

Village of Breckenridge (989) 842-3109  
 204 S. Saginaw St.  
 Breckenridge, MI 48815  
[www.breckenridge.org](http://www.breckenridge.org)

**Greater Gratiot Development, Inc.**  
 136 South Main, Ithaca, MI 48847  
 Ph: (989) 875-2083  
[www.gratiot.org](http://www.gratiot.org)

For more information on Gratiot County's 5 Certified Business Parks, visit [www.gratiot.org](http://www.gratiot.org) or Scan this Smartphone QR Code:



**WOLVERINE ENGINEERS & SURVEYORS, INC.**  
 989-866-1500  
 4400 Westwood Drive, Ithaca, MI 48847  
 By: Wolverine Engineers & Surveyors, Inc.

## St. Louis Woodside Industrial Centre

St. Louis, Gratiot County, Michigan, USA Updated: August 2015

For more information on available properties or current companies, click on the available parcel or company logo.



**Legend**

- Available site
- Available building
- Park boundaries
- Established lot line
- Combination lot line
- Conceptual lot line

City of St. Louis (989) 68-2137  
 318 W. Saginaw St.  
 St. Louis, MI 48880  
[www.stlouis.org](http://www.stlouis.org)

**Greater Gratiot Development, Inc.**  
 136 South Main, Ithaca, MI 48847  
 Ph: (989) 875-2083  
[www.gratiot.org](http://www.gratiot.org)

For more information on Gratiot County's 5 Certified Business Parks, visit [www.gratiot.org](http://www.gratiot.org) or Scan this Smartphone QR Code:



**WOLVERINE ENGINEERS & SURVEYORS, INC.**  
 989-866-1500  
 4400 Westwood Drive, Ithaca, MI 48847  
 By: Wolverine Engineers & Surveyors, Inc.

## South Ithaca Industrial Park

Ithaca, Gratiot County, Michigan, USA Updated: August 2015

For more information on available properties or current companies, click on the available parcel or company logo.



**Legend**

- Available site
- Park boundaries
- Established lot line
- Combination lot line
- Conceptual lot line

City of Ithaca (989) 875-3200  
 129 W. Emerson St.  
 Ithaca, MI 48847  
[www.ithacami.com](http://www.ithacami.com)

**Greater Gratiot Development, Inc.**  
 136 South Main, Ithaca, MI 48847  
 Ph: (989) 875-2083  
[www.gratiot.org](http://www.gratiot.org)

For more information on Gratiot County's 5 Certified Business Parks, visit [www.gratiot.org](http://www.gratiot.org) or Scan this Smartphone QR Code:

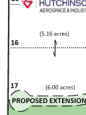

**WOLVERINE ENGINEERS & SURVEYORS, INC.**  
 989-866-1500  
 4400 Westwood Drive, Ithaca, MI 48847  
 By: Wolverine Engineers & Surveyors, Inc.

# Your Team for Success

Successful economic development coordinates many activities and players within a market area to create a business friendly environment. Long-term success depends on consistent engagement year after year.

GGDI is proud to be a partner of the Michigan Economic Development Corporation. Statewide business information may be found at [www.michiganbusiness.org](http://www.michiganbusiness.org)

GGDI is pleased to work with all local municipalities. The principal local partners working with GGDI include:



## City of Alma

Phillip Moore, City Manager  
pmoore@ci.alma.mi.us  
Aeric Ripley, Downtown Development  
aripley@ci.alma.mi.us  
(989) 463-8336

## Gratiot Area Chamber of Commerce

chamber@gratiot.org  
(989) 463-5525

## Pine River Township

Kevin Beeson, Township Supervisor  
supervisor@pinerivertwp.org  
(989) 681-5523

## Village of Ashley

Steve Moffit, Village President  
ashleyvillage@bearnnet.net  
(989) 847-3050

## Gratiot County

Jeff Huff, County Administrator  
jhuff@gratiotmi.com  
(989) 875-5261

## City of St. Louis

Kurt Giles, City Manager  
kgiles@stlouismi.com  
Phil Hansen, Downtown Development  
phansen@stlouismi.com  
(989) 681-2137

## Village of Breckenridge

Jeff Ostrander, Village Manager  
manager@breckenridgemi.com  
(989) 842-3109

## City of Ithaca

Chris Yonker, City Manager  
manager@ithacami.com  
(989) 875-3200

*\*GGDI works with all local units of government as opportunities arise. Examples include countywide master planning and commercial-scale wind energy development. Both required extensive countywide coordination.*

# JANUARY

### About Greater Graftot Development, Inc.

For more information, visit [www.greatertgd.com](http://www.greatertgd.com)

Greater Graftot Development, Inc. is a 501(c)(3) non-profit organization that was formed in 1991 to promote economic development in Graftot County, Michigan. Our mission is to create jobs and improve the quality of life in our community. We do this by providing financial assistance and technical support to local businesses and organizations. We also provide training and job placement services to help our residents find employment. Our services are provided to all residents of Graftot County, Michigan, regardless of their race, ethnicity, or religion. We are proud to be a part of our community and to help our residents succeed.

# FEBRUARY

### Plasti-Print, Inc.

2013 Project: 16000 sq. ft. building expansion and additional equipment

2012 Project: 1991 Expansion (Expansion of 1991 building and additional equipment)

Plasti-Print, Inc. is a leading manufacturer of plastic products in Graftot County, Michigan. In 2013, the company completed a major expansion project, adding 16,000 square feet of new building space and purchasing additional equipment to increase production capacity. In 2012, the company also completed a significant expansion project, adding 19,911 square feet of new building space and purchasing additional equipment. These projects have allowed Plasti-Print to continue to grow and serve its customers more effectively.

# MARCH

### SHILOH

2013 Project: \$1.2 million expansion project and additional equipment

2012 Project: \$1.2 million expansion project and additional equipment

SHILOH is a leading manufacturer of metal products in Graftot County, Michigan. In 2013, the company completed a major expansion project, adding \$1.2 million worth of new building space and purchasing additional equipment. In 2012, the company also completed a significant expansion project, adding \$1.2 million worth of new building space and purchasing additional equipment. These projects have allowed SHILOH to continue to grow and serve its customers more effectively.

# APRIL

### Workforce Development

2013 Project: \$1.2 million expansion project and additional equipment

2012 Project: \$1.2 million expansion project and additional equipment

Workforce Development is a leading provider of workforce training and development services in Graftot County, Michigan. In 2013, the organization completed a major expansion project, adding \$1.2 million worth of new building space and purchasing additional equipment. In 2012, the organization also completed a significant expansion project, adding \$1.2 million worth of new building space and purchasing additional equipment. These projects have allowed Workforce Development to continue to grow and serve its community more effectively.

# MAY

### Celebrating Small Businesses in Graftot County

2013 Project: \$1.2 million expansion project and additional equipment

2012 Project: \$1.2 million expansion project and additional equipment

Celebrating Small Businesses in Graftot County is a leading provider of small business support and assistance services in Graftot County, Michigan. In 2013, the organization completed a major expansion project, adding \$1.2 million worth of new building space and purchasing additional equipment. In 2012, the organization also completed a significant expansion project, adding \$1.2 million worth of new building space and purchasing additional equipment. These projects have allowed Celebrating Small Businesses to continue to grow and serve its community more effectively.

# JUNE

### Graftot County: Exploring Where You Live!

2013 Project: \$1.2 million expansion project and additional equipment

2012 Project: \$1.2 million expansion project and additional equipment

Graftot County: Exploring Where You Live! is a leading provider of community information and resources in Graftot County, Michigan. In 2013, the organization completed a major expansion project, adding \$1.2 million worth of new building space and purchasing additional equipment. In 2012, the organization also completed a significant expansion project, adding \$1.2 million worth of new building space and purchasing additional equipment. These projects have allowed Graftot County: Exploring Where You Live! to continue to grow and serve its community more effectively.

# JULY

### Growing Graftot: Farm to Table Agriculture

2013 Project: \$1.2 million expansion project and additional equipment

2012 Project: \$1.2 million expansion project and additional equipment

Growing Graftot: Farm to Table Agriculture is a leading provider of farm-to-table agriculture support and assistance services in Graftot County, Michigan. In 2013, the organization completed a major expansion project, adding \$1.2 million worth of new building space and purchasing additional equipment. In 2012, the organization also completed a significant expansion project, adding \$1.2 million worth of new building space and purchasing additional equipment. These projects have allowed Growing Graftot: Farm to Table Agriculture to continue to grow and serve its community more effectively.

# AUGUST

### Powell

2013 Project: \$1.2 million expansion project and additional equipment

2012 Project: \$1.2 million expansion project and additional equipment

Powell is a leading provider of professional services in Graftot County, Michigan. In 2013, the organization completed a major expansion project, adding \$1.2 million worth of new building space and purchasing additional equipment. In 2012, the organization also completed a significant expansion project, adding \$1.2 million worth of new building space and purchasing additional equipment. These projects have allowed Powell to continue to grow and serve its community more effectively.

# SEPTEMBER

### AVIA e-STEM

2013 Project: \$1.2 million expansion project and additional equipment

2012 Project: \$1.2 million expansion project and additional equipment

AVIA e-STEM is a leading provider of STEM education and workforce training services in Graftot County, Michigan. In 2013, the organization completed a major expansion project, adding \$1.2 million worth of new building space and purchasing additional equipment. In 2012, the organization also completed a significant expansion project, adding \$1.2 million worth of new building space and purchasing additional equipment. These projects have allowed AVIA e-STEM to continue to grow and serve its community more effectively.

# OCTOBER

### Graftot County Fair

2013 Project: \$1.2 million expansion project and additional equipment

2012 Project: \$1.2 million expansion project and additional equipment

Graftot County Fair is a leading provider of community events and entertainment services in Graftot County, Michigan. In 2013, the organization completed a major expansion project, adding \$1.2 million worth of new building space and purchasing additional equipment. In 2012, the organization also completed a significant expansion project, adding \$1.2 million worth of new building space and purchasing additional equipment. These projects have allowed Graftot County Fair to continue to grow and serve its community more effectively.

# NOVEMBER

### LEND

2013 Project: \$1.2 million expansion project and additional equipment

2012 Project: \$1.2 million expansion project and additional equipment

LEND is a leading provider of financial services in Graftot County, Michigan. In 2013, the organization completed a major expansion project, adding \$1.2 million worth of new building space and purchasing additional equipment. In 2012, the organization also completed a significant expansion project, adding \$1.2 million worth of new building space and purchasing additional equipment. These projects have allowed LEND to continue to grow and serve its community more effectively.

# DECEMBER

### Celebrate the Holiday Season in Graftot County!

2013 Project: \$1.2 million expansion project and additional equipment

2012 Project: \$1.2 million expansion project and additional equipment

Celebrate the Holiday Season in Graftot County! is a leading provider of holiday events and entertainment services in Graftot County, Michigan. In 2013, the organization completed a major expansion project, adding \$1.2 million worth of new building space and purchasing additional equipment. In 2012, the organization also completed a significant expansion project, adding \$1.2 million worth of new building space and purchasing additional equipment. These projects have allowed Celebrate the Holiday Season in Graftot County! to continue to grow and serve its community more effectively.

The companies, organizations, and developments highlighted in this calendar are representative of recent projects, initiatives, and services in Graftot County. The projects and developments cross the entire county and involve almost all economic sectors. GDI focuses on projects which are of base economic significance. If you have an idea or know of a project opportunity, please contact GDI.



**Greater Graftot Development, Inc.**  
 136 South Main, Ithaca, MI 48847  
 Ph: (989) 875-2083  
 www.greatertgd.org