





# Gratiot Area Water Authority



In an act of collaboration, the cities of Alma and St. Louis have come together to create the Gratiot Area Water Authority. Upon completion of construction, the Authority will provide high-quality, reliable water to Alma, St. Louis, and sections of Bethany and Pine River townships. The project is expected to be completed by 2015.

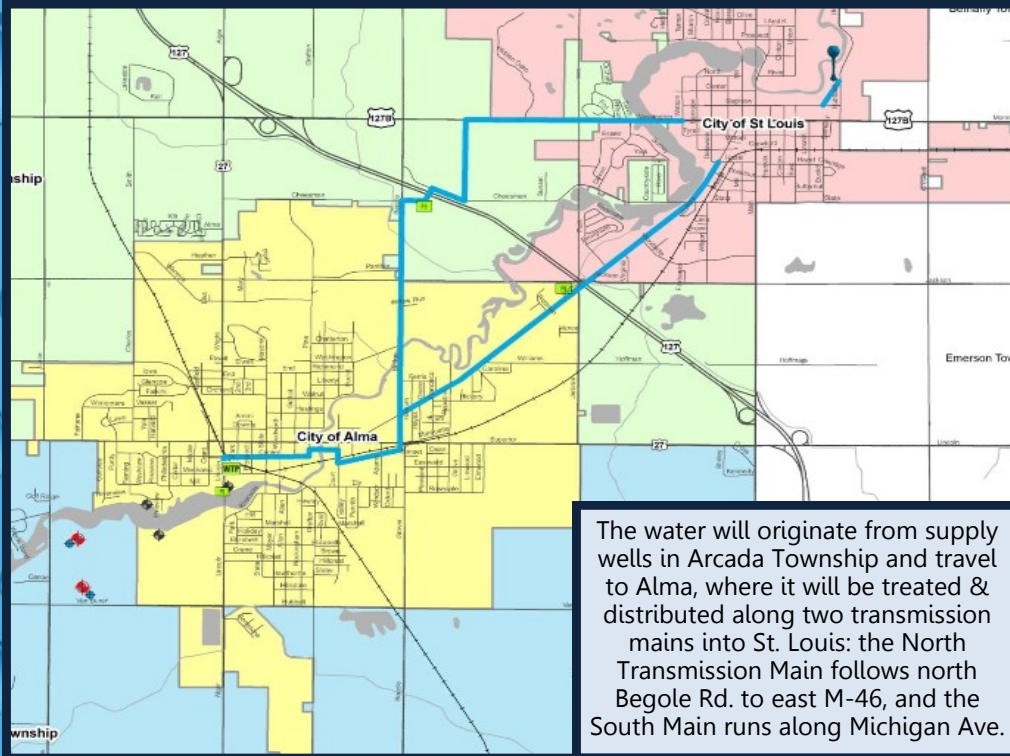

The water will originate from supply wells in Arcada Township and travel to Alma, where it will be treated & distributed along two transmission mains into St. Louis: the North Transmission Main follows north Begole Rd. to east M-46, and the South Main runs along Michigan Ave.



Crossing the Pine River To install the North Transmission Main that leads into St. Louis, a directional bore under the Pine River along M-46 was accomplished.



The Alma Water Plant will be expanded to accommodate a total use of 6 million gallons / day. Currently, Alma and St. Louis combined use an average of 2 million gallons / day. This preserves existing capacity for future opportunities.

*"The Gratiot Area Water Authority will bring the cities of Alma and St. Louis closer together. When we meet about water, we end up talking about other opportunities & problems that we can solve jointly."*

-Phil Moore  
Alma City Manager

*"This project is a fine example of what can be accomplished when local governments work together. St. Louis appreciates our partnership with the City of Alma and the efforts leading to a long-term safe and reliable water supply for our customers."*

-Kurt Giles  
St. Louis City Manager



# January 2015

Sunday	Monday	Tuesday	Wednesday	Thursday	Friday	Saturday
28	29	30	31 New Year's Eve	1 New Year's Day Kwanzaa ends	2	3
4	5	6	7	8	9	10
11	12	13	14	15	16	17
18	19 Martin Luther King, Jr. Day	20	21	22	23	24
25	26	27	28	29	30	31

Collaborating to shape the Gratiot Community....



**Greater Gratiot  
Development, Inc.**

136 South Main, Ithaca, MI 48847  
Ph: (989) 875-2083  
www.gratiot.org

Notes:

---



---



---



---

# Connecting the Dots: Collaboration Required



GGDI works with many organizations to bring services to Gratiot County. Through collaboration, Gratiot businesses, municipalities, and citizens are able to do business at a local, regional, state, and international level. The organizations listed below are only a few of many that partner with GGDI. For more information on each organization and how the services can benefit you or your business, please visit [www.gratiot.org](http://www.gratiot.org) or each organization's website.

The Michigan Economic Development Corporation (MEDC) is the state's marketing arm and lead advocate for business development, talent and jobs, tourism, film, and digital media incentives, arts and cultural grants, and overall economic growth. The MEDC offers a number of business assistance services and capital programs for business attraction and acceleration, entrepreneurship, strategic partnerships, talent enhancement, and urban and community development. GGDI is an MEDC incorporating partner with current membership on the MEDC's Collaborative Development Council (CDC), which provides program and policy advice. For more information, please visit [michiganbusiness.org](http://michiganbusiness.org)



## MICHIGAN STATE UNIVERSITY Extension

MSU Extension (MSUE) provides research-based education to help individuals and communities address critical issues, needs, and opportunities in areas such as agriculture, business development, community, and 4-H & youth development.

[www.msue.anr.msu.edu/county/info/gratiot](http://www.msue.anr.msu.edu/county/info/gratiot)



Central Area Michigan Works! Consortium

GGDI is a member of the Central Area Michigan Works! Consortium's Workforce Investment Board (WIB). The WIB is responsible for the development, implementation, and oversight of a local workforce development system that serves the needs of employers and job seekers for today and tomorrow.

[www.camwc.org](http://www.camwc.org)



**MiEIBC**  
MICHIGAN  
ENERGY INNOVATION  
BUSINESS COUNCIL

The Michigan Energy Innovation Business Council (MiEIBC) is a business trade association that represents companies in Michigan's growing advanced energy sector.

[www.mieibc.org](http://www.mieibc.org)



The Michigan Manufacturing Technology Center (MMTC) helps Michigan's small and medium-sized businesses compete and grow through personalized services fitted to meet their individual needs.

[www.mmtc.org](http://www.mmtc.org)



The Michigan Small Business Development Center (SBDC) provides counseling, training, and market research for new ventures and existing small businesses. Gratiot County's service location is based at Mid-Michigan Community College in Mt. Pleasant.

[www.sbdc-michigan.org](http://www.sbdc-michigan.org)



The East Michigan Council of Governments (EMCOG) is a regional forum comprised of 14 counties that works for the betterment of all member counties and the region as a whole. EMCOG is directly responsible for a variety of federal, state, and local planning and project implementation programs.

[www.emcog.org](http://www.emcog.org)



Department of  
**AGRICULTURE**  
& Rural Development

The Michigan Department of Agriculture and Rural Development (MDARD) protects, preserves, and promotes the food, agricultural, environmental, and economic interests of the people of Michigan.

[www.michigan.gov/mda](http://www.michigan.gov/mda)

# February 2015

Sunday	Monday	Tuesday	Wednesday	Thursday	Friday	Saturday
1	2	3	4	5	6	7
8	9	10	11	12	13	14 Valentine's Day
15	16 Presidents Day	17	18	19	20	21
22	23	24	25	26	27	28

Collaborating to shape the Gratiot Community....



**Greater Gratiot  
Development, Inc.**

136 South Main, Ithaca, MI 48847  
Ph: (989) 875-2083  
www.gratiot.org

Notes:

---

---

---

---

# Wind Development is Powerful in Gratiot County

In the summer of 2014, Exelon Generation expanded Beebe Community Wind Farm by adding 21 turbines to its portfolio. In total, Beebe Community Wind now has 55 turbines across 15,000 acres that produce 132 MW of energy. Power generated from the expansion is being purchased by the Lansing Board of Water & Light and the Michigan Public Power Agency, of which the City of St. Louis is a member. Between the two wind farms, Beebe Community Wind Farm, LLC and Gratiot County Wind, LLC (Michigan's largest wind farm), Gratiot County is now home to 188 turbines. The original development and continued expansions of both farms are critical to Gratiot County's future due to the economic benefits they provide (listed to the right).

## Benefits

- **\$10.3 million** in additional tax revenue since 2012
  - ◇ **\$4 million** to Gratiot County
  - ◇ **\$5.13 million** to local school districts and RESDs
  - ◇ **\$1.21 million** to local townships
- 300 temporary skilled construction jobs and 21 permanent full-time maintenance jobs
- Land payments to benefit approximately 350 families (total payments equate to a new industrial payroll with approximately 25 jobs)

\*These numbers reflect all components of wind development that occurred in Gratiot County, including both wind farms (Gratiot County Wind, LLC and Beebe Community Wind Farm, LLC) and necessary electrical upgrades from ITC.

A significant benefit from wind development has been the construction of four substations and other necessary electrical infrastructure upgrades that were completed by ITC. These electrical updates will sustain Gratiot's economy by adding tax revenue, increasing power reliability, and making the area more attractive for new businesses.



# March 2015

Sunday	Monday	Tuesday	Wednesday	Thursday	Friday	Saturday
1	2	3	4	5	6	7
8 Daylight Saving (Start)	9	10	11	12	13	14
15	16	17 St. Patrick's Day	18	19	20	21
22	23	24	25	26	27	28
29	30	31	1	2	3 Good Friday Passover begins	4

Collaborating to shape the Gratiot Community....



**Greater Gratiot  
Development, Inc.**

136 South Main, Ithaca, MI 48847  
Ph: (989) 875-2083  
www.gratiot.org

Notes:

---



---



---



---

# Railroad Service in Gratiot County

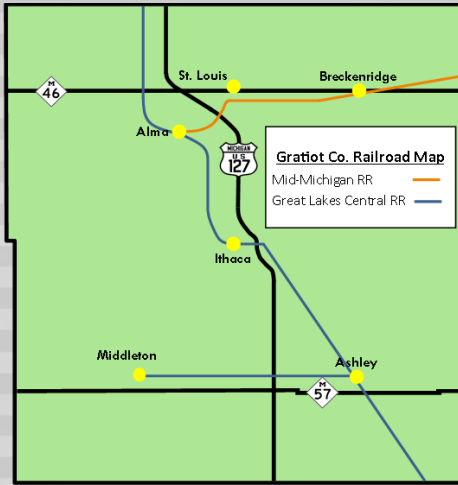

Gratiot County is very fortunate to have two railroad systems that service the area and connect to other rail systems throughout Michigan & North America. Great Lakes Central Railroad (GLC), a regional railroad, provides a north-south line through Gratiot, and Mid-Michigan Railroad (MMRR), a short line railroad, provides an east-west line. Having such railroad service is a tremendous asset for both existing and incoming industries of all types. Rail offers a low-cost, fuel-efficient mode of transportation for moving bulk items and commodities.

Gratiot County has properties with rail access available for development. For information, contact GGD.I.

## Great Lakes Central Railroad

[www.glcrailroad.com](http://www.glcrailroad.com)

- GLC is the largest regional railroad in Michigan with 400 miles of track stretching through Central and Northern Michigan.
- GLC runs north and south through Gratiot County, passing through Alma, Ithaca, and Ashley with a branch line to Middleton.
- Major customers in Gratiot County include MAC (Michigan Agricultural Commodities)-Middleton and Agro-Culture Liquid Fertilizers-Ashley



Ithaca, Michigan



Breckenridge, Michigan



## Mid-Michigan Railroad

[www.gwrr.com](http://www.gwrr.com)

- MMRR was purchased by Genesee & Wyoming from RailAmerica in 2012. It consists of two lines in Michigan for a total of 32 miles: one from Alma to Paines & another from Lowell to Greenville.
- MMRR runs east and west through Gratiot County, passing through Alma, St. Louis, and Breckenridge.
- Major customers in Gratiot County include MAC (Michigan Agricultural Commodities)-Breckenridge and Terry Asphalt Materials-Alma



# April 2015

Sunday	Monday	Tuesday	Wednesday	Thursday	Friday	Saturday
29	30	31	1	2	3 Good Friday Passover begins	4
5 Easter	6	7	8	9	10	11 Passover ends
12	13	14	15	16	17	18
19	20	21	22 Earth Day Administrative Professionals' Day	23	24	25
26	27	28	29	30	1	2

Collaborating to shape the Gratiot Community....



**Greater Gratiot  
Development, Inc.**

136 South Main, Ithaca, MI 48847  
Ph: (989) 875-2083  
www.gratiot.org

Notes:

---



---



---



---

# Small Business is Big Business in Gratiot County

National Small Business Week will be celebrated May 4 - 8, 2015. The federal government classifies a business as small based on the number of employees and type of industry. Most businesses in the manufacturing sector are considered a small business if they have 500 employees or less. This is the case for almost all manufacturers in Gratiot County, showing how critical small businesses are in all areas of the Gratiot economy. For this reason, it is crucial to support the development and expansion of local small businesses. Below are a few examples of manufacturers in Gratiot County that continue to grow as small businesses. (FTE refers to full-time equivalent positions)

**Aircraft Precision Products, Inc.**  
 Ithaca, MI FTE: 65.5  
[www.aircraftprecision.net](http://www.aircraftprecision.net)  
 Recent equipment upgrades at APPI include state-of-the-art CNC machines and inspection equipment to help meet evermore demanding customer quality requirements.



**Garr Tool Company**  
 Pine River Township, MI  
 FTE: 135  
[www.garrtool.com](http://www.garrtool.com)  
 New technology allows for increased production of specialized cutting tools (left) and higher efficiency with equipment such as a robotic packaging center (right).

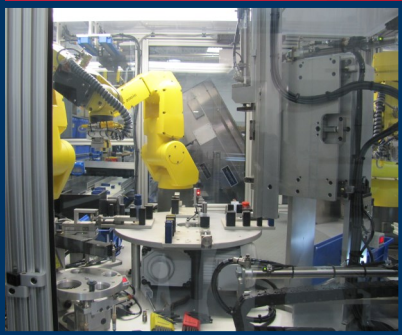

**Integrity Fab & Machine Inc.**  
 Breckenridge, MI FTE: 41  
[www.ifabm.com](http://www.ifabm.com)  
 The high-definition plasma cutting table (below) and large vertical bridge mill (right) enable increased production and tolerance capabilities for large part manufacturing.



**Momentum Industries, Inc.**  
 St. Louis, MI FTE: 14  
[www.momentumind.com](http://www.momentumind.com)  
 This year, Momentum invested in new equipment that manufactures parts for other types of equipment that make wheels. The 120-inch splined shaft (right) is used in the production of large agriculture equipment wheels and is produced with the machine on the left.

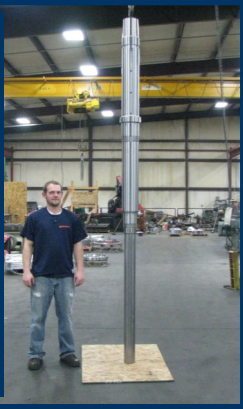

**Production Machining of Alma**  
 Alma, MI FTE: 23  
 Recent upgrades at PMA include the acquisition of additional CNC turning centers that provide increased high-quality production capacity.

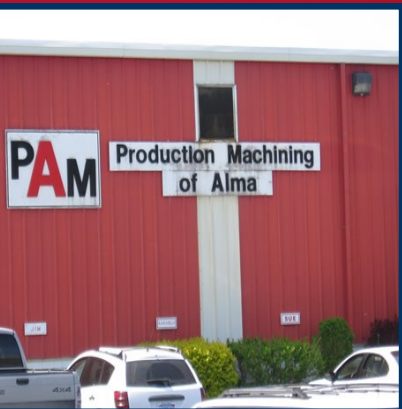

# May 2015

Sunday	Monday	Tuesday	Wednesday	Thursday	Friday	Saturday
26	27	28	29	30	1	2
3	4	5	6	7	8	9
10 Mother's Day	11	12	13	14	15	16
17	18	19	20	21	22	23
24	25 Memorial Day	26	27	28	29	30
31	1	2	3	4	5	6

Collaborating to shape the Gratiot Community....



**Greater Gratiot  
Development, Inc.**

136 South Main, Ithaca, MI 48847  
Ph: (989) 875-2083  
www.gratiot.org

Notes:

---



---



---



---

# Recreation Opportunities in Gratiot County

**Gratiot County**  
Parks & Recreation  
www.gratiotmi.com  
(989) 875-5278



## Paul Hubscher County Park Ithaca, MI



- Pavilions
- Playground
- Picnic tables & grills
- Swimming beach
- Nature trails
- Camping
- Fishing
- Softball

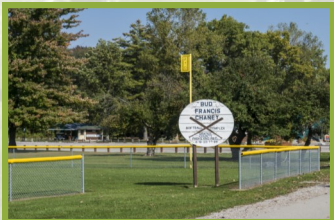

## Reed County Park North Star, MI

- Pavilions
- Playground
- Picnic tables & grills
- Swimming beach
- Nature trails
- Volleyball
- Baseball
- Disc golf



## Luneack County Park Alma, MI

Luneack Landing features a wheelchair accessible canoe/kayak launch that leads into the Pine River Canoe Trail. It has multiple parking spaces for easy access.



Gratiot County is home to the Pine and Maple rivers. The Pine River boasts a 30-mile canoe/kayak trail that runs from Riverdale to Alma. It is wheelchair accessible at Luneack Landing.



The Fred Meijer Heartland Trail is 42 miles and runs from Alma to Greenville. The smooth asphalt trail can be used for walking, biking, skating, and other non-motorized traffic.



The Alma Mountain Bike Trail is a single track of 2.5 miles and offers an exhilarating and scenic ride. It is located in Alma's Pine River Park & Outdoor Center.

Gratiot County has a multitude of outdoor recreation activities:

- Multiple city and private parks
- Breckenridge Splash Park (right)
- 9 hole and 18 hole golf courses
- Public swimming pools
- Gratiot-Saginaw State Game Area
- Maple River / Gratiot-Saginaw Connector State Game Area
- Maple River State Game Area
- Shooting ranges
- Paintball
- Soccer fields



Indoor recreation opportunities are also available:

- Live theater and music performances
- Movie theaters
- Public libraries
- Downtown shopping centers
- Bowling
- Indoor swimming pools
- Arcades
- Health clubs/gyms
- Dance lessons



# June 2015

Sunday	Monday	Tuesday	Wednesday	Thursday	Friday	Saturday
31	1	2	3	4	5	6
7	8	9	10	11	12	13
14	15	16	17	18 Ramadan begins	19	20
21 Father's Day	22	23	24	25	26	27
28	29	30	1	2	3	4 Independence Day

Collaborating to shape the Gratiot Community....



**Greater Gratiot  
Development, Inc.**

136 South Main, Ithaca, MI 48847  
Ph: (989) 875-2083  
www.gratiot.org

Notes:

---



---



---



---

# Celebrating Agriculture in Gratiot County

With almost 290,000 acres in farmland spread across 878 farms, it is easy to see why agriculture provides the foundation for growth and development in Gratiot County. The economic benefits reaped from agriculture are tremendous; in 2013, agriculture was 21% of Gratiot's tax base and employed nearly 2,500 people on farms and in agribusinesses. Societal benefits are also bountiful; farm families and agribusiness owners often take an active role in the community. In addition, there are currently over 600 4-H youth members, proving that there is a solid future in store for agriculture in Gratiot County.



Gratiot County Agriculture Statistics (2013 estimated)			
Product	State rank	Production	Value
Milk	6th	414 M lbs.	\$ 85.9 M
Soybeans	5th	3.1 M bu.	\$ 43.5 M
Corn	7th	12.1 M bu.	\$ 81.7 M
Cattle & cull cows	5th	33,000 hd.	\$ 46.8 M
Hogs	5th	140,000 hd.	\$ 26.2 M
Dry beans	6th	51,900 cwt.	\$ 2.2 M
Sugar beets	6th	250,000 T	\$ 18.1 M
Corn silage	4th	300,000 T	\$ 14.7 M
Wheat	7th	1.7 M bu.	\$ 12.8 M
<b>Total:</b>			<b>\$331.9 M</b>



## Rural Urban Day - July 16, 2015

2015 will be the 40th Anniversary of Rural Urban Day, which is an annual community picnic that celebrates the bond between the rural & urban communities in Gratiot County. With a steak dinner, car & tractor show, and petting zoo, there is fun for the whole family that you will not want to miss!



2014 Farm Family of the Year:  
Tom & Shawyn Sparks and family  
(Newark Township, Michigan)



2014 Business of the Year:  
Peters Hardware  
(St. Louis, Michigan)

# July 2015

Sunday	Monday	Tuesday	Wednesday	Thursday	Friday	Saturday
28	29	30	1	2	3	4 Independence Day
5	6	7	8	9	10	11
12	13	14	15	16 Rural Urban Day	17 Ramadan ends	18
19	20	21	22	23	24	25
26 Parents' Day	27	28	29	30	31	1

Collaborating to shape the Gratiot Community....



**Greater Gratiot  
Development, Inc.**

136 South Main, Ithaca, MI 48847  
Ph: (989) 875-2083  
www.gratiot.org

Notes:

---



---



---



---

# The Big Dill:

## Specialty Crops in Gratiot County

featuring



Agriculture in Gratiot County consists of more than just beans, corn, and livestock. A variety of specialty crops are also produced, adding significant value to the agricultural base of Gratiot County. Sparks Pickle Co. plays a significant role in agriculture with its production of fresh pickles and brine stock. "Brine stock" refers to cucumbers that have undergone a lactic acid fermentation process; "green stock" refers to cucumbers that have not. In addition to pickle tanking, the company farms nearly 1,500 acres of beans, wheat, and corn.



There are 550 tanks in the tank yard. Each tank is 10 feet deep (7 feet in the ground and 3 feet above) and on average, 14 feet in diameter.



Each tank holds approximately 1,200 bushels of pickles for an overall tanking capacity of 700,000 bushels.



Processed pickles are distributed to stores and restaurants such as McDonald's, Wendy's, Burger King, Subway, and Quiznos.



Sparks Pickle Co. has 9 full-time employees year-round. During "Green Season," when cucumbers are harvested locally, 65 additional employees are hired. "Green Season" runs from mid-July to October.



Shawyn & Tom Sparks are the owners of Sparks Pickle Co. They purchased the business in September of 2001. The company and offices sit on approximately 95 acres. It has operated in Gratiot County for over 30 years. The Sparks Family was named "Farm Family of the Year" in Gratiot County for 2014. For more information, please see the month of July.



# August 2015

Sunday	Monday	Tuesday	Wednesday	Thursday	Friday	Saturday
26 Parents' Day	27	28	29	30	31	1
2	3	4	5	6	7	8
9	10	11	12	13	14	15
16	17	18	19	20	21	22
23	24	25	26	27	28	29
30	31	1	2	3	4	5

Collaborating to shape the Gratiot Community....



**Greater Gratiot  
Development, Inc.**

136 South Main, Ithaca, MI 48847  
Ph: (989) 875-2083  
www.gratiot.org

Notes:

---



---



---



---



# GI-TEC

Gratiot-Isabella Technical Education Center

Serving the following school districts:

- Alma
- Ashley
- Beal City
- Breckenridge
- Fulton
- Ithaca
- Mt. Pleasant
- Sacred Heart
- Shepherd
- St. Louis

In November 2013, a Career and Technical Education (CTE) millage was passed in Gratiot and Isabella counties to support CTE opportunities for students in the Gratiot-Isabella Regional Education Service District. Programs are provided at the Alma Tech Center and the Mt. Pleasant Tech Center. Between the two campuses, 1,100 students participate in 19 CTE programs. From an economic development standpoint, vocational education is a critical component to ensuring good jobs for a skilled and reliable workforce for future generations. For additional information, please visit [www.giresd.net](http://www.giresd.net)



## Trade & Industry

- Agri-science
- Automotive Technology
- Construction Trades
- Electronics & Computer Repair
- Interior Design
- Machine Trades
- Mechatronics
- Printing / Graphics
- Radio / TV Production
- Small Engines
- Welding

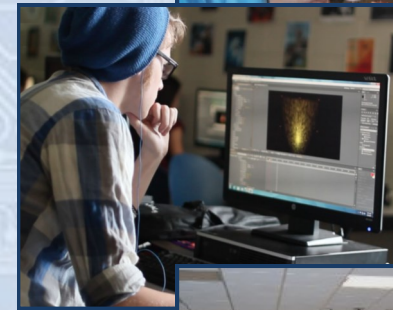

## Life Management

- Cosmetology
- Educational Careers
- Culinary Arts
- Health Careers/CENA

## Business

- Accounting
- Business Management
- Digital Media / Web Production
- Marketing

# September 2015

Sunday	Monday	Tuesday	Wednesday	Thursday	Friday	Saturday
30	31	1	2	3	4	5
6	7 Labor Day	8	9	10	11 Patriot Day	12
13 Rosh Hashanah begins Grandparents' Day	14	15 Rosh Hashanah ends	16	17	18	19
20	21	22 Yom Kippur begins	23 Yom Kippur ends	24	25	26
27	28	29	30	1	2	3

Collaborating to shape the Gratiot Community....



**Greater Gratiot  
Development, Inc.**

136 South Main, Ithaca, MI 48847  
Ph: (989) 875-2083  
www.gratiot.org

Notes:

---



---



---



---

**Gratiot  
Signs  
& Designs**

**Mid Michigan  
upholstery  
& awning**

Alma, MI

Employees (FTE): 8.5

Established: 1982

Mid Michigan Upholstery & Awning is a manufacturer of custom-crafted upholstery, awnings, and graphics.

2014 Project: New location

*Before*



*After*



*"Thank you, Greater Gratiot Development, Inc., for giving us the opportunity to be one of the largest upholstery, awning, and graphics businesses in the State of Michigan."*

**-Rod McCormick  
Founder and Owner**



[www.midmichiganupholstery.com](http://www.midmichiganupholstery.com)



# October 2015

Sunday	Monday	Tuesday	Wednesday	Thursday	Friday	Saturday
27	28	29	30	1	2	3
4	5	6	7	8	9	10
11	12 Columbus Day	13	14	15	16 National Boss Day	17
18	19	20	21	22	23	24
25	26	27	28	29	30	31 Halloween

Collaborating to shape the Gratiot Community....



**Greater Gratiot  
Development, Inc.**

136 South Main, Ithaca, MI 48847  
Ph: (989) 875-2083  
www.gratiot.org

Notes:

---



---



---



---

# Business to Business in Gratiot County

Business to business activity leads to a stronger economy in Gratiot County due to increased local sales, employment, & diverse businesses. When a business engages in business to business activity, it collaborates with other businesses during the design & manufacturing process for a product. As a result, a business may learn new innovative processes & capabilities that it can use in its own course of business. This results in a number of new opportunities for the business. Follow the example below to see how a Monosem planter is manufactured with many services & components produced in Gratiot County.

**Misenhelder Welding (Ithaca) completes welding work for the Monosem planters.**



**Steel Fabrication**

**C & S Steel** C & S Steel (Ithaca) will laser cut, bend, roll, & weld steel to form parts.

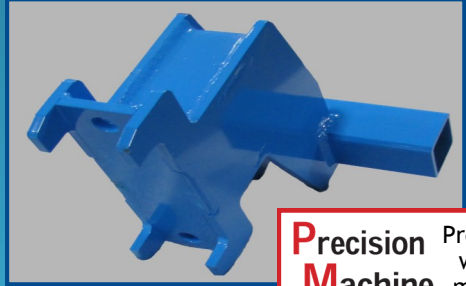

**Parts & Pieces**

**Precision Machine** Precision Machine (Ithaca) will complete precision machining for Monosem.



**POWDER COAT OF CENTRAL MICHIGAN**

Powder Coat of Central Michigan (Ithaca) provides the superior blue coating for all parts & components.



**High-Quality Blue Coating**

**Assembly: Nuts & Bolts**

**Alma Bolt Company**

Alma Bolt Company (Alma) supplies a variety of high-quality bolts to Monosem.

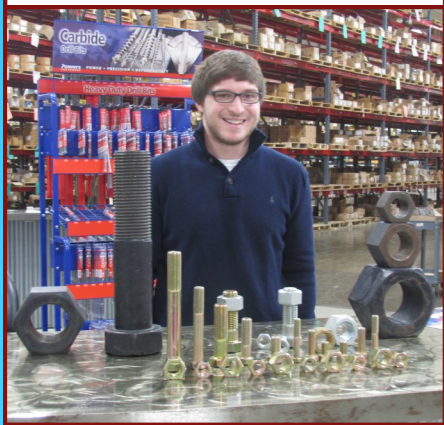

**Quality Control**

**Anchor Danly**

Quality control gauging for the lift mechanism is provided by a die manufactured by Anchor Danly (Ithaca).

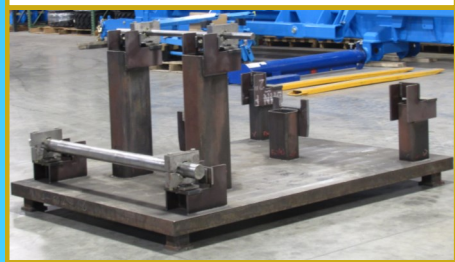

Complete assembly occurs at the Monosem plant in Ithaca, Michigan. Planters range from 6 to 90 feet. Planters are sold both locally and internationally; Janson Equipment in Breckenridge sells many planters that are used on local farms.

# November 2015

Sunday	Monday	Tuesday	Wednesday	Thursday	Friday	Saturday
<b>1</b> Daylight Saving (End)	<b>2</b>	<b>3</b>	<b>4</b>	<b>5</b>	<b>6</b>	<b>7</b>
<b>8</b>	<b>9</b>	<b>10</b>	<b>11</b> Veterans Day	<b>12</b>	<b>13</b>	<b>14</b>
<b>15</b>	<b>16</b>	<b>17</b>	<b>18</b>	<b>19</b>	<b>20</b>	<b>21</b>
<b>22</b>	<b>23</b>	<b>24</b>	<b>25</b>	<b>26</b> Thanksgiving	<b>27</b>	<b>28</b>
<b>29</b>	<b>30</b>	<b>1</b>	<b>2</b>	<b>3</b>	<b>4</b>	<b>5</b>

Collaborating to shape the Gratiot Community....



**Greater Gratiot  
Development, Inc.**

136 South Main, Ithaca, MI 48847  
Ph: (989) 875-2083  
www.gratiot.org

Notes:

---



---



---



---

# Village of Ashley Country Christmas



This holiday season be sure to visit the Village of Ashley's Country Christmas. The celebration takes place in Ashley's downtown area, which features a variety of dining options and unique shopping opportunities. Adults and children alike will enjoy the seasonal activities and picturesque atmosphere as they await the arrival of the North Pole Express. For dates and times, please visit

[www.michigansteamtrain.com/north-pole-express/](http://www.michigansteamtrain.com/north-pole-express/) or [www.villageofashleycountrychristmas.blogspot.com](http://www.villageofashleycountrychristmas.blogspot.com)



The North Pole Express, or the Pere Marquette #1225, is the actual train depicted in the book and movie titled *The Polar Express*. The #1225 is located in Owosso, MI at the Steam Railroading Institute and travels to Ashley, MI to visit the "North Pole."



## Activities:

- ★ Visit Santa Claus
- ★ Decorate cookies with Mrs. Claus
- ★ Build a toy in Santa's Workshop
- ★ Enjoy a horse-drawn carriage ride
- ★ Meet Santa's Reindeer
- ★ Listen to Christmas carolers
- ★ Play children's games
- ★ Observe a juggler, chainsaw carver, and illusionist



# December 2015

Sunday	Monday	Tuesday	Wednesday	Thursday	Friday	Saturday
29	30	1	2	3	4	5
6 Hanukkah begins	7	8	9	10	11	12
13	14 Hanukkah ends	15	16	17	18	19
20	21	22	23	24 Christmas Eve	25 Christmas Day	26 Kwanzaa begins
27	28	29	30	31 New Year's Eve	1 New Year's Day Kwanzaa ends	2

Collaborating to shape the Gratiot Community....



**Greater Gratiot  
Development, Inc.**

136 South Main, Ithaca, MI 48847  
Ph: (989) 875-2083  
www.gratiot.org

Notes:

---



---



---



---

# Michigan Certified Business Parks

Business development projects are only possible if sufficient appropriate land is available. Gratiot County boasts five Michigan Certified Business Parks. Certified Business Parks are typically government-owned and have readily available municipal services and aesthetically pleasing features. These combined factors make for a streamlined development process. Certified Business Parks are promoted internationally by the Michigan Economic Developers Association and the Michigan Economic Development Corporation.

Alma Industrial Park  
 Breckenridge Industrial, Technology and Agribusiness Park  
 Ithaca Industrial Park  
 St. Louis Woodside Industrial Centre  
 South Ithaca Industrial Park



MICHIGAN CERTIFIED BUSINESS PARK

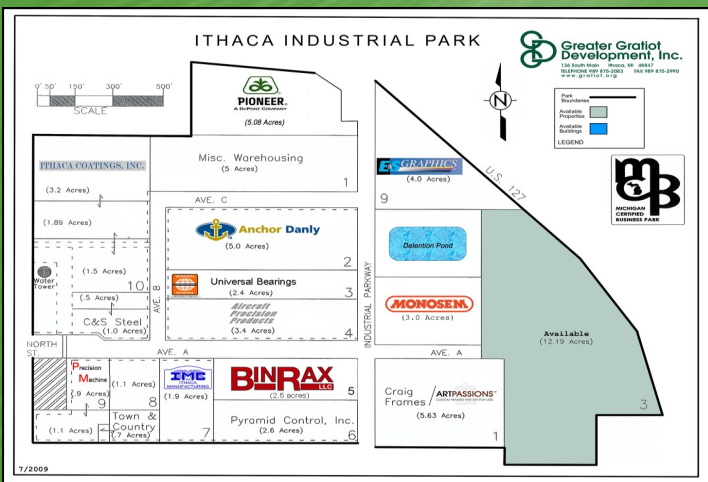
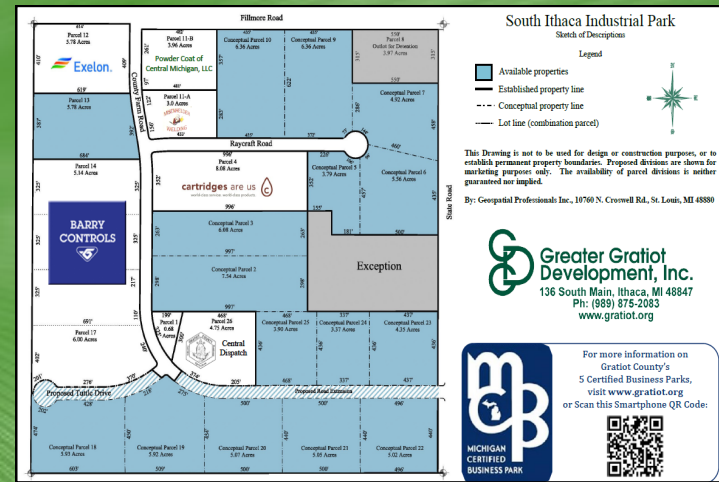
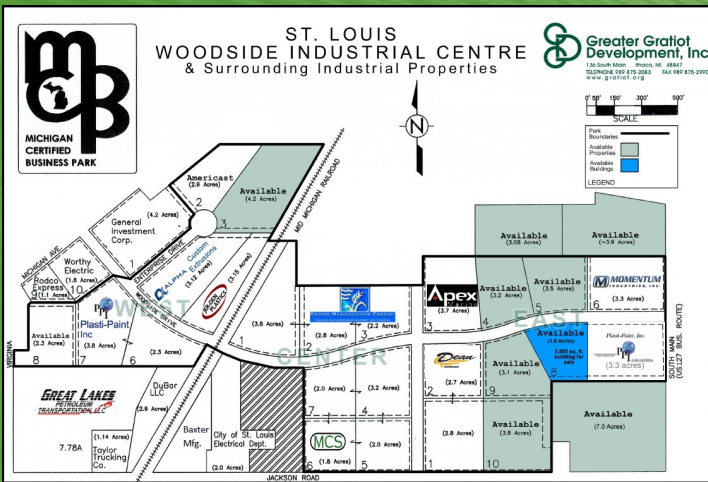

For map downloads, scan the smartphone QR code or visit [www.gratiot.org](http://www.gratiot.org)

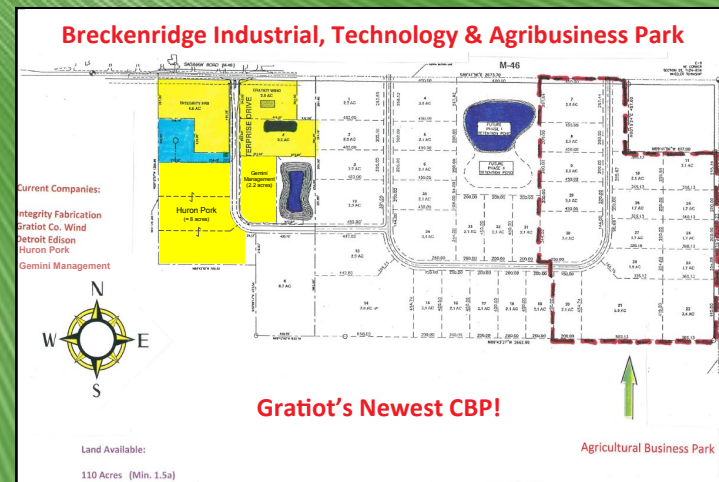
# Your Team for Success

Successful economic development coordinates many activities and players within a market area to create a business friendly environment. Long-term success depends on consistent engagement year after year.

GGDI is proud to be a partner of the Michigan Economic Development Corporation. Statewide business information may be found at [www.michiganbusiness.org](http://www.michiganbusiness.org)

GGDI is pleased to work with all local municipalities. The principal local partners working with GGDI include



## City of Alma

Phillip Moore, City Manager  
pmoore@ci.alma.mi.us  
Aeric Ripley, Downtown Development  
aripley@ci.alma.mi.us  
(989) 463-8336

## Gratiot Area Chamber of Commerce

Jayne Norris, Executive Director  
jayne.norris@gratiot.org  
(989) 463-5525

## Pine River Township

Kevin Beeson, Township Supervisor  
supervisor@pinerivertwp.org  
(989) 681-5523

## Village of Ashley

Steve Moffit, Village President  
ashleyvillage@bearnnet.net  
(989) 847-3050

## Gratiot County

Jeff Huff, County Administrator  
jhuff@gratiotmi.com  
(989) 875-5282

## City of St. Louis

Kurt Giles, City Manager  
kgiles@stlouismi.com  
Phil Hansen, Downtown Development  
phansen@stlouismi.com  
(989) 681-2137

## Village of Breckenridge

Jeff Ostrander, Village Manager  
manager@breckenridgemi.com  
(989) 842-3109

## City of Ithaca

Barb Fandell, City Clerk  
bfandell@ithacami.com  
or manager@ithacami.com  
(989) 875-3200

*\*GGDI works with all local units of government as opportunities arise. Examples include countywide master planning and commercial-scale wind energy development. Both required extensive countywide coordination.*

# JANUARY

**Collaboration Required: Connecting the Dots.**

Greater Gratiot County is an area of collaboration that spans from Montmorency to St. Louis and is supported by 2025.

Greater Gratiot County is an area of collaboration that spans from Montmorency to St. Louis and is supported by 2025.

Greater Gratiot County is an area of collaboration that spans from Montmorency to St. Louis and is supported by 2025.

# SEPTEMBER

**GL-TEC: The Technology Connection.**

Greater Gratiot County is an area of collaboration that spans from Montmorency to St. Louis and is supported by 2025.

Greater Gratiot County is an area of collaboration that spans from Montmorency to St. Louis and is supported by 2025.

Greater Gratiot County is an area of collaboration that spans from Montmorency to St. Louis and is supported by 2025.

# FEBRUARY

**Collaboration Required: Connecting the Dots.**

Greater Gratiot County is an area of collaboration that spans from Montmorency to St. Louis and is supported by 2025.

Greater Gratiot County is an area of collaboration that spans from Montmorency to St. Louis and is supported by 2025.

Greater Gratiot County is an area of collaboration that spans from Montmorency to St. Louis and is supported by 2025.

# OCTOBER

**Gratiot & Design: Mid-Michigan Photography & Design.**

Greater Gratiot County is an area of collaboration that spans from Montmorency to St. Louis and is supported by 2025.

Greater Gratiot County is an area of collaboration that spans from Montmorency to St. Louis and is supported by 2025.

Greater Gratiot County is an area of collaboration that spans from Montmorency to St. Louis and is supported by 2025.

# MARCH

**Wind Development is Powerful in Gratiot County.**

Greater Gratiot County is an area of collaboration that spans from Montmorency to St. Louis and is supported by 2025.

Greater Gratiot County is an area of collaboration that spans from Montmorency to St. Louis and is supported by 2025.

Greater Gratiot County is an area of collaboration that spans from Montmorency to St. Louis and is supported by 2025.

# JULY

**Celebrating Agriculture in Gratiot County.**

Greater Gratiot County is an area of collaboration that spans from Montmorency to St. Louis and is supported by 2025.

Greater Gratiot County is an area of collaboration that spans from Montmorency to St. Louis and is supported by 2025.

Greater Gratiot County is an area of collaboration that spans from Montmorency to St. Louis and is supported by 2025.

# NOVEMBER

**Business to Business in Gratiot County.**

Greater Gratiot County is an area of collaboration that spans from Montmorency to St. Louis and is supported by 2025.

Greater Gratiot County is an area of collaboration that spans from Montmorency to St. Louis and is supported by 2025.

Greater Gratiot County is an area of collaboration that spans from Montmorency to St. Louis and is supported by 2025.

# APRIL

**Railroad Service in Gratiot County.**

Greater Gratiot County is an area of collaboration that spans from Montmorency to St. Louis and is supported by 2025.

Greater Gratiot County is an area of collaboration that spans from Montmorency to St. Louis and is supported by 2025.

Greater Gratiot County is an area of collaboration that spans from Montmorency to St. Louis and is supported by 2025.

# AUGUST

**Specialty Crops in Gratiot County.**

Greater Gratiot County is an area of collaboration that spans from Montmorency to St. Louis and is supported by 2025.

Greater Gratiot County is an area of collaboration that spans from Montmorency to St. Louis and is supported by 2025.

Greater Gratiot County is an area of collaboration that spans from Montmorency to St. Louis and is supported by 2025.

# DECEMBER

**Holiday Christmas.**

Greater Gratiot County is an area of collaboration that spans from Montmorency to St. Louis and is supported by 2025.

Greater Gratiot County is an area of collaboration that spans from Montmorency to St. Louis and is supported by 2025.

Greater Gratiot County is an area of collaboration that spans from Montmorency to St. Louis and is supported by 2025.

The companies, organizations, and developments highlighted in this calendar are representative of recent projects, initiatives, and services in Gratiot County. The projects and developments cross the entire county and involve almost all economic sectors. If you have an idea or know of a project opportunity, please contact GDI.



**Greater Gratiot Development, Inc.**  
 136 South Main, Ithaca, MI 48847  
 Ph: (989) 875-2083  
 www.gratiot.org